

NOTE: CLOCKWISE IN GIVES COUNTERCLOCKWISE OUT

MT2XX 9/4/03 SHEET 1 OF 2

CONSULT FACTORY  
FOR SPECIAL  
CONFIGURATIONS

**INPUT  
PATTERN**

BLANK IS STD.  
OTHERS  
AVAILABLE

RATIO: 2:1  
TORQUE: 500 FT-LB [678 N-M]  
TEMP: -20°/150°F [129°/66°C]  
WEIGHT: 28 LBS [12.7 KG]

**GREASED FOR LIFE**

**MANUAL MITER GEAR  
COMMERCIAL GRADE**

**DYNATORQUE**

1934 E. SHERMAN MUSKEGON, MI 49444-1824  
(231) 739-1377 FAX (231) 739-4514  
WWW.DYNATORQUE.COM

**MT2  
MITER  
2:1**

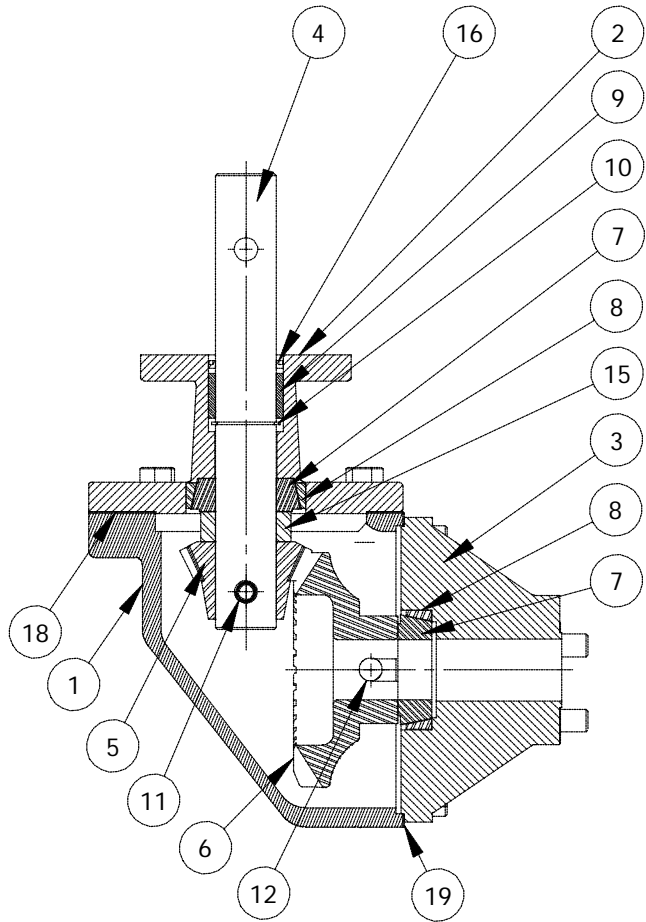

SECTION A-A

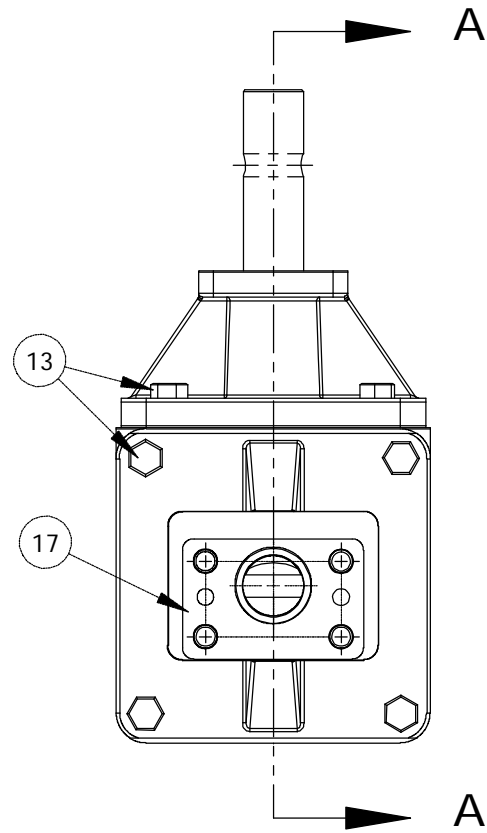

ITEM	QTY.	DESCRIPTION	ITEM	QTY.	DESCRIPTION
1	1	HOUSING, MITER, MACH.	13	12	HHCS, 3/8-16 X 1.00 LG
2	1	MITER FLANGE, INPUT	14	4	WASHER,SPLIT,.375
3	1	MITER FLANGE, OUTPUT	15	1	WORM SPACER
4	1	SHAFT, MITER, 2:1, STD	16	1	LIP SEAL,1.00
5	1	BEVEL GEAR PINION	17	1	GASKET, SPUR-UNIT
6	1	GEAR, MITER 2:1, OUTPUT	18	1	GASKET, MITER, INPUT
7	2	ROLLER BRG, CONE	19	1	GASKET, MITER, OUTPUT
8	2	ROLLER BRG, CUP			
9	1	BEARING SLV,1.25,1.00,.75			
10	1	EXT LOCK RING, 1.00, LOW PROFILE			
11	1	COIL PIN,.375,1.25			
12	1	GROOVE PIN,.375,1.50			

**DYNATORQUE**  
 1934 E. SHERMAN MUSKEGON, MI 49444-1824  
 (231) 739-1377 FAX (231) 739-4514  
 WWW.DYNATORQUE.COM

**MT2  
 MITER  
 2:1**