

LOCATE HOOP WELD SEAM
AT END OF SPOKE
SURFACE TO BE
SMOOTH AND FLUSH

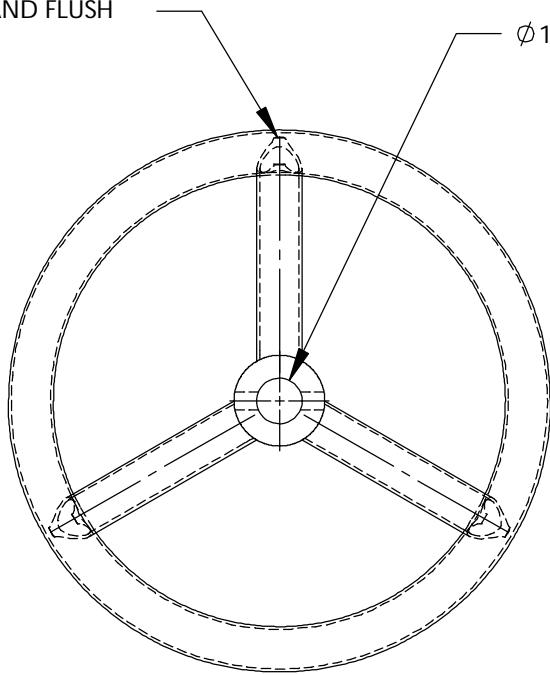

$\phi 1.010^{+.010}_{-.005}$ [25.65^{+0.25}_{-0.13}]

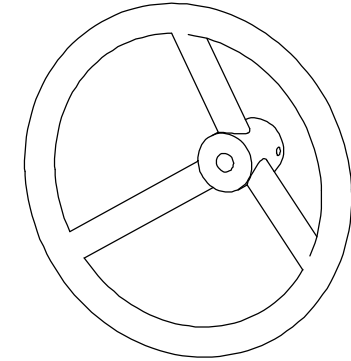
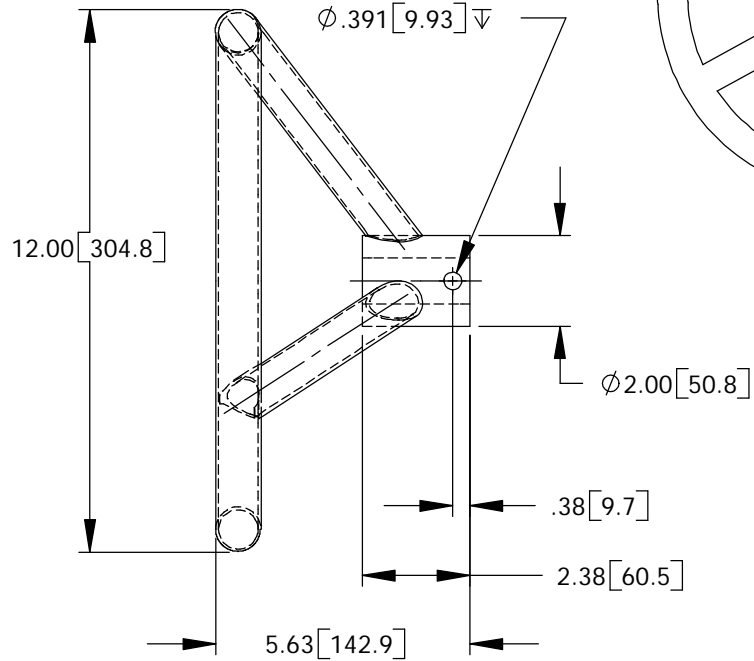

PAINT: BLACK EPOXY POWDERCOAT
CONSTRUCTION: WELDED ϕ 1.00 STEEL TUBING

NOTE: 1. MOUNTING HARDWARE INCLUDED.
2. SEAL WELD ALL JOINTS, WITH ALL ROUGH
EDGES & WELD SPATTER REMOVED.

	12/09/02 BWA TWD	BY DATE	CHKD	This drawing, the structural design disclosed therein and the technical data and engineering service represented thereby are the exclusive property of Dyna-Torque Incorporated. It is to be returned to Dyna-Torque upon written request and it is not to be reproduced in whole or in part or disclosed to anyone else without the express written consent of Dyna-Torque Incorporated.	TOLERANCE UNLESS NOTED X \pm .06 XX \pm .02 XXX \pm .005 DEGREE \pm 1/2°	DYNATORQUE 1934 EAST SHERMAN BLVD MUSKEGON, MI 49444-1824 (231) 739-1377 FAX (231) 739-4514	
	REDRAWN IN SW ER# 12711	DESCRIPTION			NAME OF PART HWRR12		
E	REV				NOTE HW	PART NO. 11-321	REV E