

PAINT: BLACK EPOXY POWDERCOAT
 CONSTRUCTION: WELDED ϕ 1.00 STEEL TUBING

$\phi 1.010^{+.010}_{-.005}$ [25.65^{+0.25}_{-0.13}]

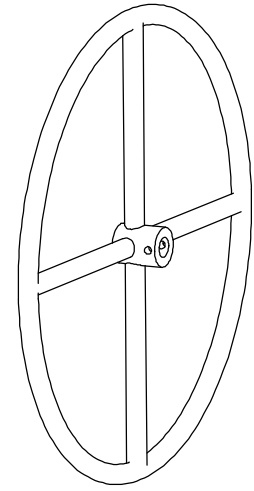
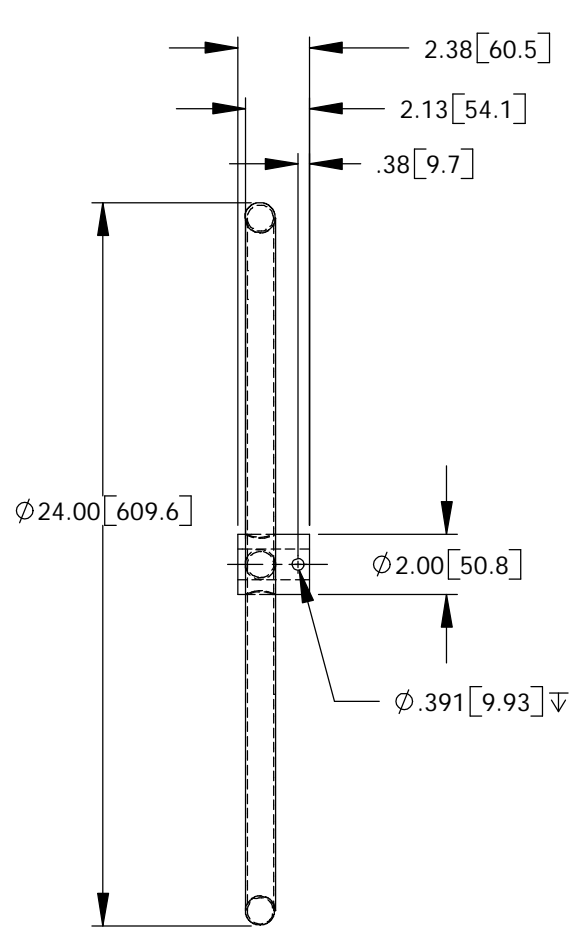

NOTE: 1. MOUNTING HARDWARE INCLUDED.
 2. SEAL WELD ALL JOINTS, WITH ALL ROUGH EDGES & WELD SPATTER REMOVED.

REV	DESCRIPTION	DATE	CHKD	BY
B	REDRAWN IN SW ER# 12727	12/12/02	BIM TWD	

This drawing, the structural design disclosed therein and the technical data and engineering service represented thereby are the exclusive property of Dyna-Torque Incorporated. It is to be returned to Dyna-Torque upon written request and it is not to be reproduced in whole or in part or disclosed to anyone else without the express written consent of Dyna-Torque Incorporated.

TOLERANCE UNLESS NOTED
 X $\pm .06$
 XX $\pm .02$
 XXX $\pm .005$
 DEGREE $\pm 1/2^\circ$

DYNATORQUE
 1934 EAST SHERMAN BLVD
 MUSKEGON, MI 49444-1824
 (231) 739-1377 FAX (231) 739-4514

NAME OF PART **HWR24**

NOTE

HW

PART NO. **11-330** REV **B**