

CONSULT FACTORY FOR SPECIAL SHAFT & INDICATOR CONFIGURATIONS

<p>POS 1 POS 2 (STD)</p>		<p>KEYWAY DIAGRAM</p> <p>IN OPEN POS.</p>	<p>300 FT-LB STOPS BRONZE WORM WHEEL GREASED FOR LIFE PLATED STANDARD SHAFT MAX STEM HEIGHT: 4.44 [112.8] WORM WHEEL RECESS: .33 [8.4]</p>	<p>HANDWHEEL</p> <p>RECOMMENDED ϕ: 30 IN RIM PULL AT MAX TORQUE: 80 LBS TURNS FOR 90°: 60</p>	<p>RATIO: 240:1 TORQUE: 60,000 IN LBS [6780 N-M] TEMPERATURE: -20° TO 150 °F [-29° TO 66 °C] EST. WEIGHT: 145 LBS [66 KGS]</p>		
<p>HOUSING MOUNTING PATTERN</p>				<p>BORE & KEY</p>		<p>MANUAL 1/4 TURN ACTUATOR AWWA GRADE</p>	
MAX	MAX ON CENTER	STD	MIN	MAX	STD	<p>DYNATORQUE WWW.DYNATORQUE.COM DT90W</p>	
$\phi 11.750$ 3/4-10 UNC	$\phi 11.750$ 3/4-10 UNC	$\phi 10.250$ 3/4-10 UNC	$\phi 6.500$ 3/4-10 UNC	$\phi 4.500$ 1.25 X .625 KEY	$\phi 3.250$.750 KEY @C		

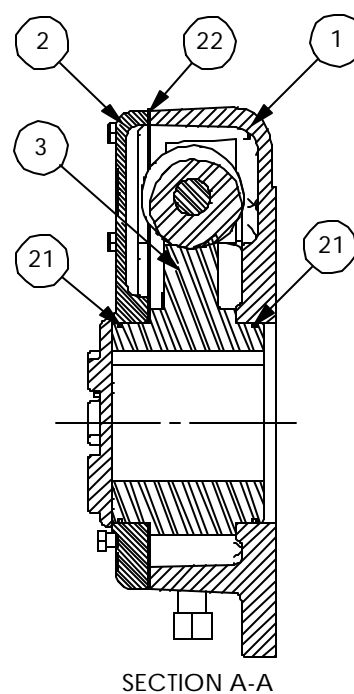

SECTION A-A

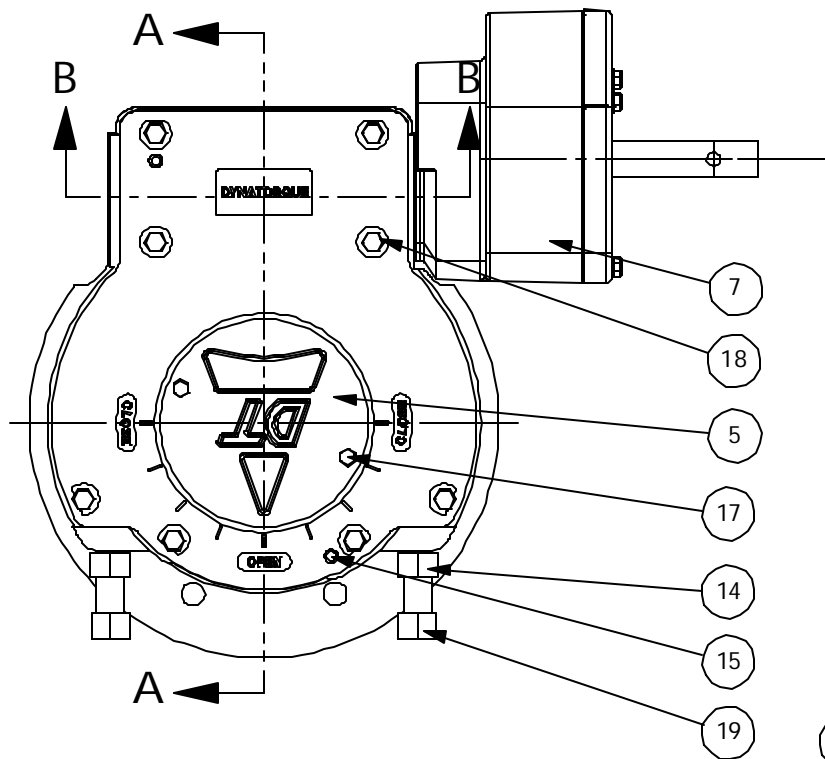
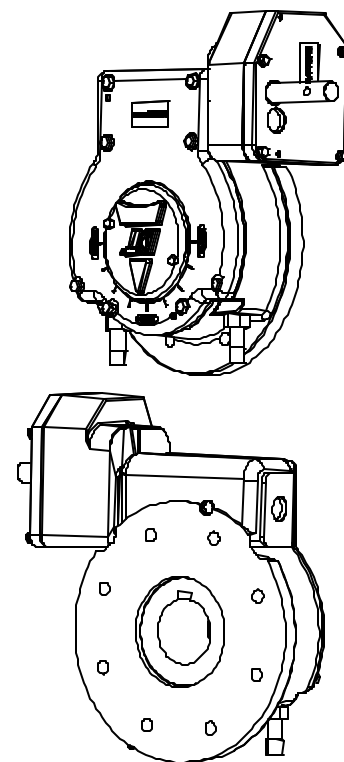

- 6 UNIT IS PAINTED BLACK OXIDE PRIMER.
- 9 UNIT BEARINGS, O-RINGS AND GEAR TEETH ARE GREASED.

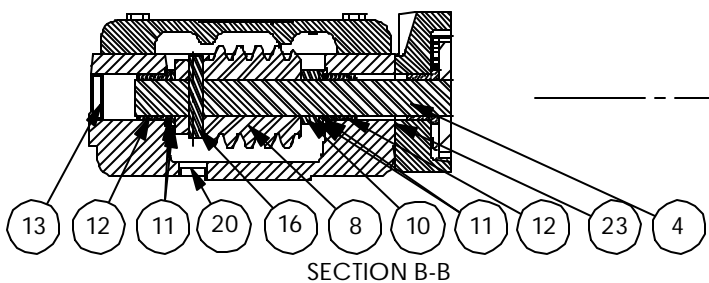

SECTION B-B

ITEM	QTY.	DESCRIPTION	ITEM	QTY.	DESCRIPTION
1	1	HOUSING, DT60	15	2	DOWEL PIN, .375, 1.00
2	1	COVER, DT60	16	1	GROOVE PIN, .375, 2.25
3	1	W/WHEEL, DT60W	17	2	HHCS, 1/4-20 X .75 LG
4	1	SHAFT, DT90	18	8	HHCS, 3/8-16 X 1.50 LG
5	1	INDICATOR, DT60, STD	19	2	SHSS, 3/4-10 X 4.50, SS
6	1	PAINT, PRIMER, BLACK OXIDE	20	1	EXP. PLUG, .750, .25, 300 SERIES SS
7	1	SPUR, 4:1	21	2	O-RING, 2-160
8	1	WORM, DT60, STD	22	1	COVER GASKET, DT 60/90
9	1	GREASE, COMMERCIAL GRADE	23	1	GASKET
10	1	SPACER			
11	4	BEARING RACE TORR TRD 1625	DYNATORQUE WWW.DYNATORQUE.COM		DT90W
12	2	BEARING SLV, 1.25, 1.00, .81			
13	1	EXPANSION PLUG, 1.250, .31	9/28/05		
14	2	NUT, JAM, 3/4-10			