

CONSULT FACTORY FOR SPECIAL
SHAFT & INDICATOR CONFIGURATIONS.

| | | | | | | | | | | | | |
|----------------------------|----------------------------|----------------------------|----------------------------|-----------------------------------|--------------------------------|---|--|--|--|---|--|------------|
| POS 1 | | POS 2 (STD) | | KEYWAY DIAGRAM | | GREASED FOR LIFE PLATED STANDARD SHAFT MAX STEM HEIGHT: 2.75 [69.9] WORM WHEEL RECESS: .35 [8.9] | | HANDWHEEL RECOMMENDED ϕ : 24 IN RIM PULL AT MAX TORQUE: 82 LBS TURNS FOR 360°: 30 | | RATIO: 30:1 TORQUE: 8,000 IN LBS [904 N-M] TEMPERATURE: -20° TO 150°F [-29° TO 66°C] EST. WEIGHT: 19 LBS [8.6 KGS] | | |
| HOUSING MOUNTING PATTERN | | | | BORE & KEY | | | MANUAL MULTI TURN WORM GEAR OPERATOR COMMERCIAL GRADE | | | | | |
| MAX | MAX ON CENTER | STD | MIN | MAX | STD | MIN | DYNATORQUE 1934 E. SHERMAN MUSKEGON, MI 49444-1824 (231) 739-1377 FAX (231) 739-4514 WWW.DYNATORQUE.COM 4/1/05 | | | | | DT8 |
| ϕ 5.125 1/2-13 UNC | ϕ 4.250 1/2-13 UNC | ϕ 5.000 1/2-13 UNC | ϕ 3.125 3/8-16 UNC | ϕ 1.875 .50 X .375 KEY | ϕ 1.750 .375 KEY @C | ϕ .391 | | | | | | |

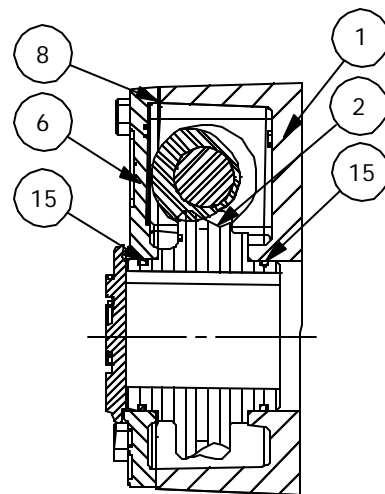

SECTION B-B

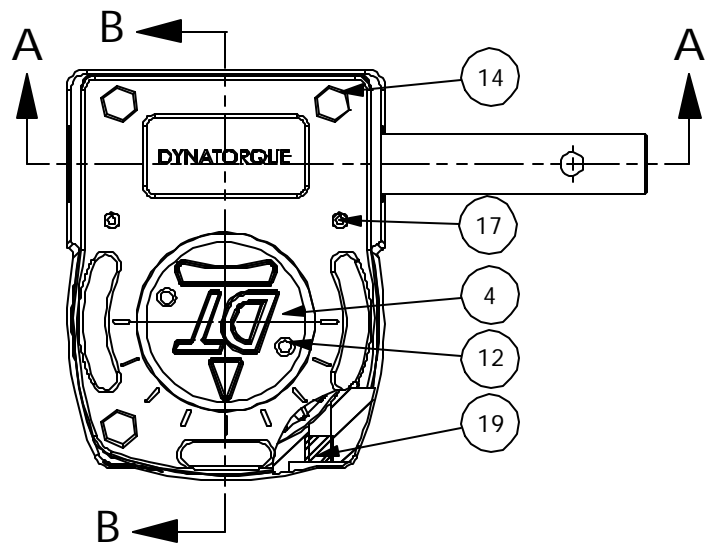
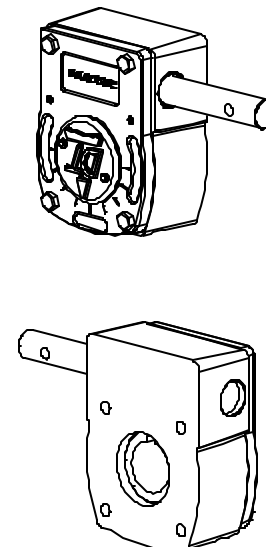

- 5 UNIT IS PAINTED BLACK OXIDE.
- 11 UNIT BEARINGS, O-RINGS, AND GEAR TEETH ARE GREASED.

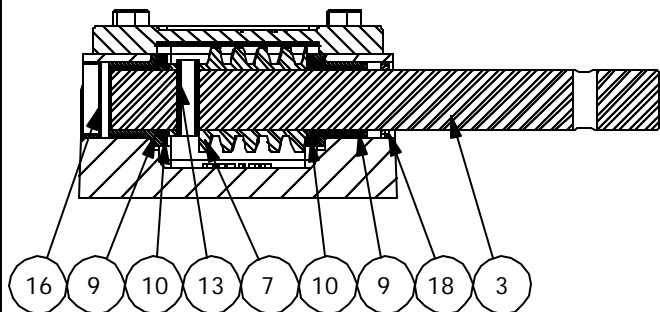

SECTION A-A

| ITEM | QTY. | DESCRIPTION | ITEM | QTY. | DESCRIPTION |
|------|------|----------------------------------|--|------|--------------------------|
| 1 | 1 | HOUSING, DT8 | 13 | 1 | COIL PIN, .375,1.25 |
| 2 | 1 | W/WHEEL,DT8,360,STD | 14 | 4 | HHCS , 3/8-16 X .875 |
| 3 | 1 | SHAFT,DT8/12,G=7.00,.391 | 15 | 2 | O-RING,2-141 |
| 4 | 1 | INDICATOR, DT7/DT8, E-COATED | 16 | 1 | EXPANSION PLUG,1.250,.31 |
| 5 | 1 | BLACK OXIDE | 17 | 2 | DOWEL PIN,.250,.75 |
| 6 | 1 | COVER, DT8, 360/180 | 18 | 1 | LIP SEAL,1.00 |
| 7 | 1 | WORM,DT8 | 19 | 2 | SET SCREW, 1/2-13, .50 |
| 8 | 1 | COVER GASKET, DT8 | <p>DYNATORQUE 1934 EAST SHERMAN BLVD MUSKEGON, MI 49444-1824 (231) 739-1377 FAX (231) 739-4514 WWW.DYNATORQUE.COM 4/1/05</p> | | |
| 9 | 2 | BEARING,FLANGED,1.250,1.000,.880 | | | |
| 10 | 2 | THRUST WASHER,1.00,.092 | | | |
| 11 | 1 | GREASE, COMMERCIAL GRADE | | | |
| 12 | 2 | PHCS,8-32,S/TAP,.5 | | | |

DT8