

SECTION A-A

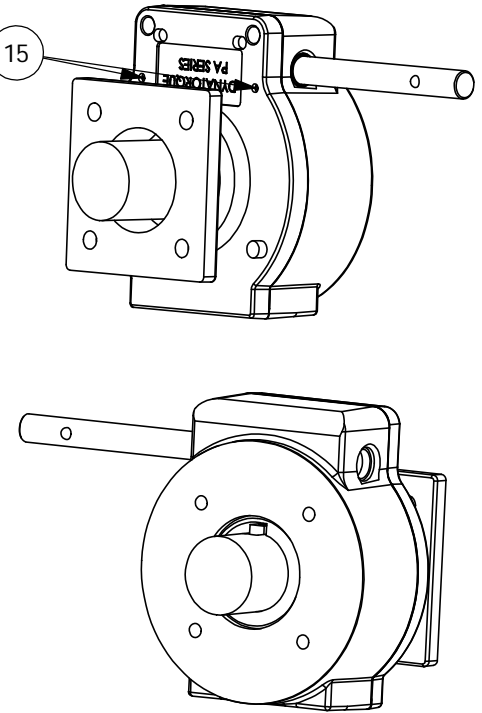

- 16 UNIT BEARINGS, ORINGS AND GEAR TEETH ARE GREASED.
- 17 UNIT HAS BLACK E-COAT.
- 19 HWRR 14" HANDWHEEL NOT SHOWN.

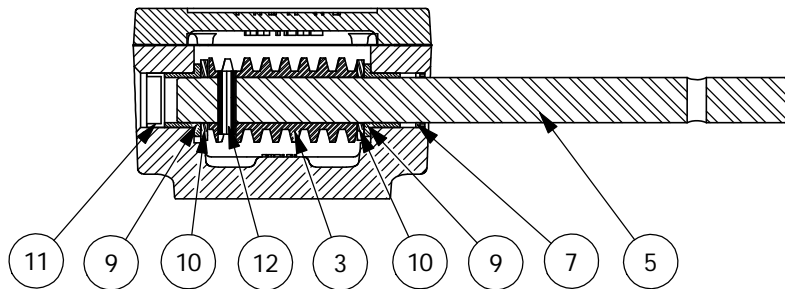

SECTION B-B

ITEM	QTY.	DESCRIPTION	ITEM	QTY.	DESCRIPTION
1	1	HSG, DT7	13	2	SET SCREW, 3/8-16, 2.25
2	1	W/WHEEL,DT7,SRD	14	2	SHCS, 1/4-20 X .87
3	1	WORM, DT7	15	2	DOWEL PIN,.188,.50
4	1	COVER DT7SD	16	1	GREASE, COMMERCIAL GRADE
5	1	SHAFT,DT3/7,G=7.00,.266,SRD	17	1	E-COAT
6	2	O-RING,2-141	18	1	DR SRD,DT7
7	1	LIP SEAL,5/8	19	1	HWRR 14"
8	1	GASKET, DT7, BUNA-N	20	2	SHCS, 1/4-20 X .38
9	2	BEARING,FLANGED,.750,.625,.50	<b>DYNATORQUE</b> WWW.DYNATORQUE.COM 9/6/07		
10	2	THRUST WASHER,.625,.092			
11	1	EXPANSION PLUG,.750,.25			
12	1	COIL PIN,.250,.88			
			<b>DT7</b> <b>SRD</b>		