

CONSULT FACTORY FOR SPECIAL SHAFT AND INDICATOR CONFIGURATIONS

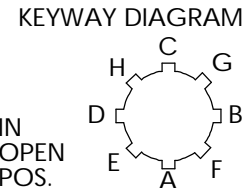
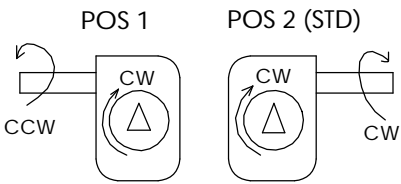

GREASED FOR LIFE  
 STAINLESS STEEL CONSTRUCTION (IRON/CRS GEARS)  
 MAX STEM HEIGHT: 2.25 [57.2]  
 WORM WHEEL RECESS: .11 [2.8]

**HANDWHEEL**  
 RECOMMENDED  $\phi$ : 18 IN  
 RIM PULL AT  
 MAX TORQUE: 86 LBS  
 TURNS FOR 90°: 12

RATIO: 48:1  
 TORQUE: 10,000 IN LBS  
 TEMPERATURE: [1130 N-M]  
 -20° TO 150°F  
 WEIGHT: [-29° TO 66°C]  
 14 LBS [6.4 KGS]

**HOUSING MOUNTING PATTERN**

**BORE & KEY**

**MANUAL 1/4 TURN ACTUATOR  
 COMMERCIAL GRADE**

MAX	MAX ON CENTER	STD	MIN	MAX	STD	MIN
$\phi$ 5.000 1/2-13 UNC	$\phi$ 5.000 1/2-13 UNC	$\phi$ 5.000 1/2-13 UNC	$\phi$ 3.250 3/8-16 UNC	$\phi$ 1.875 .500 X .375 KEY	$\phi$ 1.750 .375 KEY @C	$\phi$ .391

**DYNATORQUE**  
 1934 E. SHERMAN MUSKEGON, MI 49444-1824  
 (231) 739-1377 FAX (231) 739-4514  
 WWW.DYNATORQUE.COM

**DT7  
 SS**

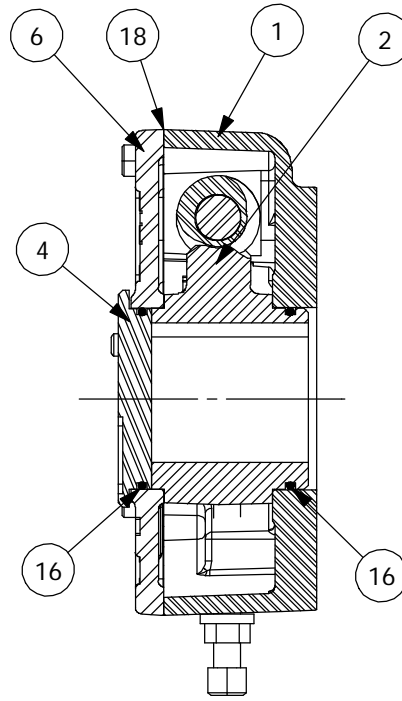
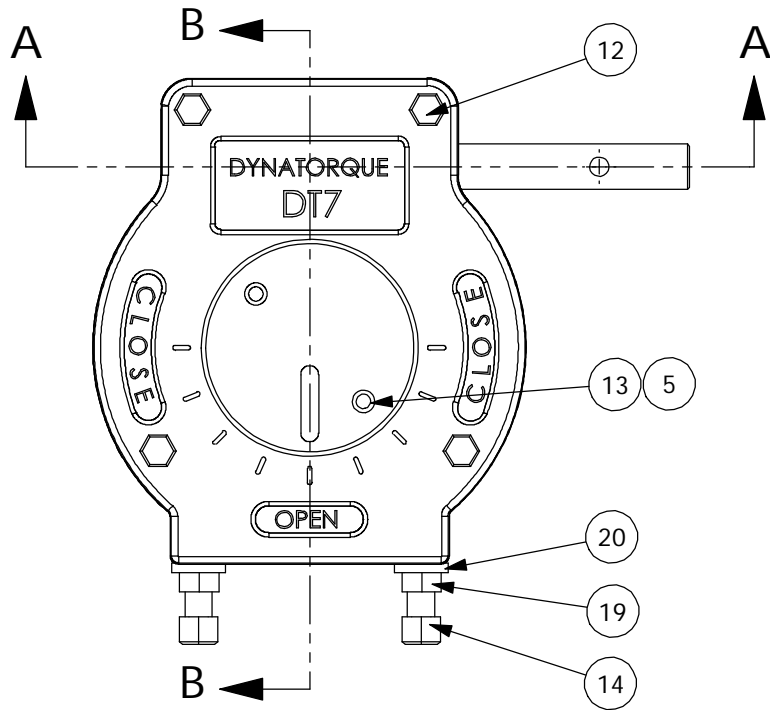

SECTION B-B

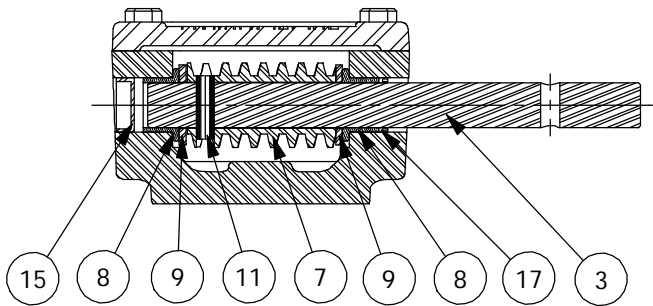
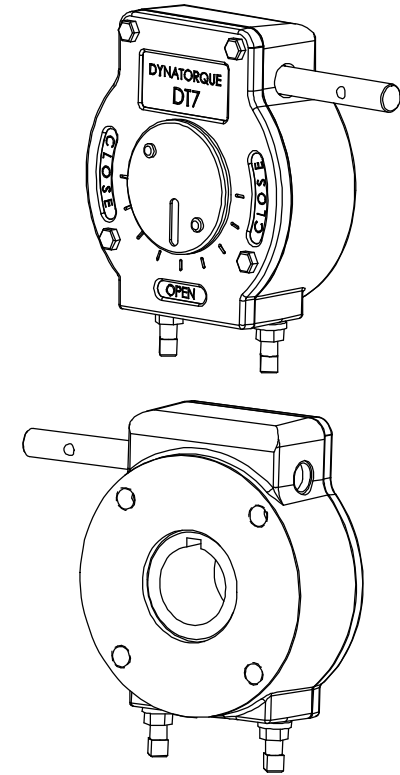

SECTION A-A

10 UNIT BEARINGS, O-RINGS AND GEAR TEETH ARE GREASED.

ITEM	QTY.	DESCRIPTION	ITEM	QTY.	DESCRIPTION
1	1	HOUSING, DT7SS	14	2	SHSS, 3/8-16 X 3.00, SS
2	1	W/WHEEL, DT7SI	15	1	EXP. PLUG, .750, .25, 300 SERIES SS
3	1	SHAFT, DT3/7, 300 SERIES SS	16	2	O-RING, 2-141
4	1	INDICATOR, DT7SS	17	1	LIP SEAL, 5/8
5	2	O-RING, 2-006	18	1	LIQUID SEALANT, LOCTITE 51580
6	1	COVER, DT7 SS, MACH	19	2	NUT, JAM, 3/8-16, SS
7	1	WORM, DT7	20	2	WASHER, BOND, 3/8, SS
8	2	BEARING, FLANGED, .750, .625, .50	<b>DYNATORQUE</b> 1934 EAST SHERMAN BLVD MUSKEGON, MI 49444-1824 (231) 739-1377 FAX (231) 739-4514 WWW.DYNATORQUE.COM		
9	2	THRUST WASHER, .625, .092			
10	1	GREASE, COMMERCIAL GRADE			
11	1	COIL PIN, .250, .88			
12	4	HHCS, 1/4-20 X .88 LG SS			
13	2	PHCS, 8-32 S/TAP, SS	<b>DT7</b> <b>SS</b>		