

CONSULT FACTORY FOR SPECIAL CONFIGURATIONS.

	SPRING HANDLE LOCKS UNIT IN ENGAGED OR DISENGAGED POSITION. UNIT SHOWN IN ENGAGED POSITION. GREASED FOR LIFE. PLATED STANDARD SHAFT.	MAX DRIVER BORE & KEY		HANDWHEEL RECOMMENDED ϕ : 10 IN RIM PULL AT MAX TORQUE: 74 LBS TURNS FOR 90°: 7.5	RATIO: 30:1 TORQUE: 3,000 IN LBS [342 N-M] TEMPERATURE: -20° TO 150°F [-29° TO 66°C] WEIGHT UNIT: 11 LBS [5 KG] DRIVER: 2 LBS [9 KG] HANDWHEEL: 7 LBS [3.2 KG]
		MAX IN LINE $\phi .750$ $.188 \times .125$ KEY	MAX $\phi .875$ $.250 \times .188$ KEY		

HOUSING MOUNTING PATTERN				COVER MOUNTING PATTERN				MANUAL 1/4 TURN ACTUATOR COMMERCIAL GRADE	
MAX	MAX ON CENTER	STD	MIN	MAX	MAX ON CENTER	STD	MIN	DYNATORQUE 1934 E. SHERMAN MUSKEGON, MI 49444-1824 (231) 739-1377 FAX (231) 739-4514 WWW.DYNATORQUE.COM	DT3 SD
$\phi 4.016$ 3/8-16	$\phi 3.750$ 3/8-16	$\phi 2.756$ 5/16-18	$\phi 1.968$ 1/4-20	$\phi 4.250$ $\phi .406$	$\phi 4.250$ $\phi .406$	$\phi 2.756$ $\phi .344$	$\phi 2.756$ $\phi .344$		

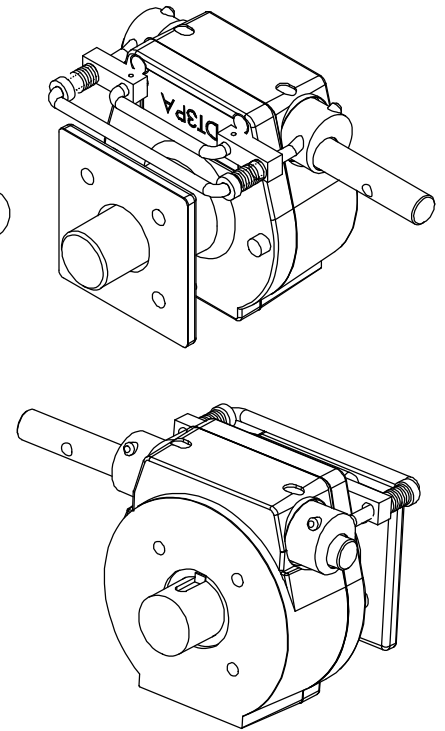
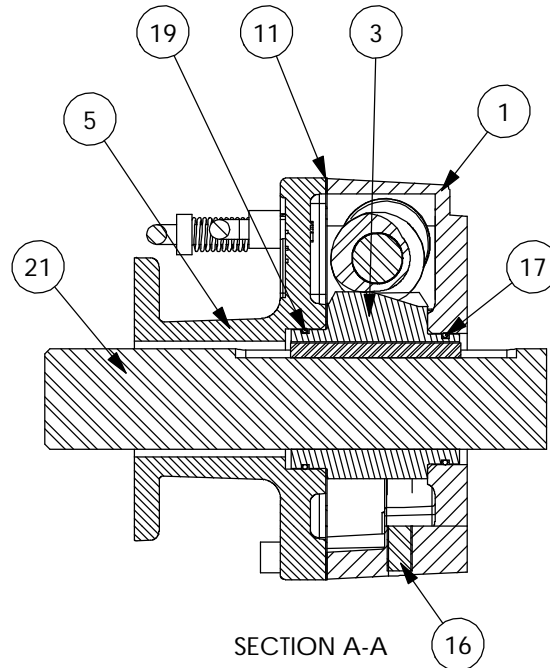
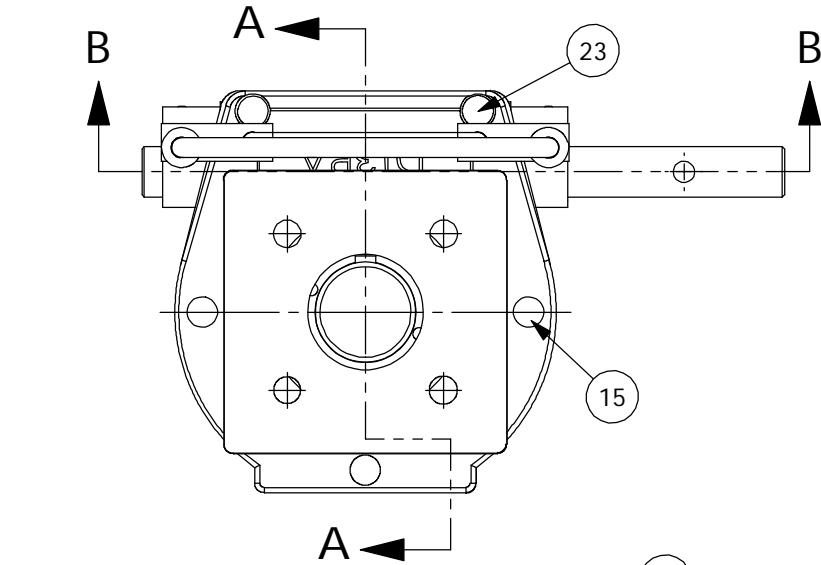

- 6 UNIT IS PAINTED BLACK OXIDE.
- 13 UNIT BEARINGS, O-RINGS AND GEAR TEETH ARE GREASED.
- 22 HWCR 10" HANDWHEEL NOT SHOWN.

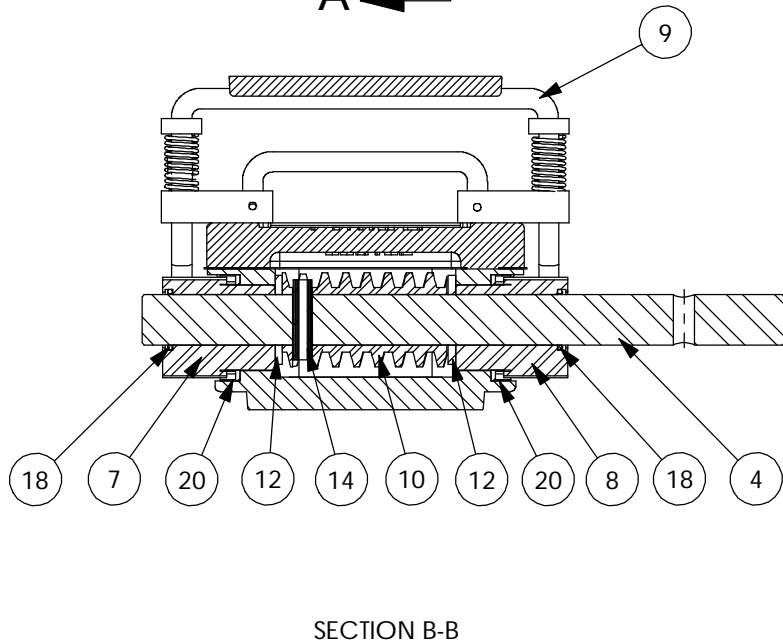

SECTION B-B

ITEM	QTY.	DESCRIPTION	ITEM	QTY.	DESCRIPTION
1	1	HOUSING, DT3SD	15	3	SHCS, 1/4-20 X .87
2	4	PLASTIC PLUG FOR SHIPPING	16	2	SET SCREW, 5/16-18
3	1	W/WHEEL,DT3	17	1	O-RING,2-028
4	1	SHAFT,DT3SD	18	2	O-RING,2-016
5	1	COVER,DT3SD	19	1	O-RING,2-028
6	1	BLACK OXIDE	20	2	LIP SEAL, 1.125
7	1	DECL BSHG, DT3SD, SS, INBOARD	21	1	DR DEL,DT3 STD, BLANK
8	1	DECL BSHG, DT3SD, SS, OUTBOARD	22	1	HWCR 10"
9	1	DECL HANDLE, DT3SD, S.S.	23	2	SHCS, 1/4-20 X .62
10	1	WORM, DT2/3/5			DYNATORQUE 1934 EAST SHERMAN MUSKEGON, MI 49444-1824 (231) 739-1377 FAX (231) 739-4514 WWW.DYNATORQUE.COM
11	1	GASKET, COVER, DT3			
12	2	THRUST WASHER,.625,.092			
13	1	GREASE, COMMERCIAL GRADE			
14	1	COIL PIN,.250,1.00			

**DT3
SD**