

CONSULT FACTORY FOR SPECIAL SHAFT AND INDICATOR CONFIGURATIONS

<p>POS 1</p>	<p>POS 2 (STD)</p>	<p>KEYWAY DIAGRAM</p> <p>IN OPEN POS.</p>	<p>GREASED FOR LIFE</p> <p>PLATED STANDARD SHAFT</p> <p>MAX STEM HEIGHT: 4.12 [104.6]</p> <p>WORM WHEEL RECESS: .41 [10.4]</p>	<p>HANDWHEEL</p> <p>RECOMMENDED ϕ: 36 IN</p> <p>RIM PULL AT MAX TORQUE: 105 LBS</p> <p>TURNS FOR 90°: 13.25</p>	<p>RATIO: 53:1</p> <p>TORQUE: 36,000 IN LBS [4068 N-M]</p> <p>TEMPERATURE: -20° TO 150°F [-29° TO 66°C]</p> <p>EST. WEIGHT: 84 LBS [38 KGS]</p>
--------------	--------------------	---	--	---	---

HOUSING MOUNTING PATTERN				BORE & KEY			MANUAL 180° ACTUATOR COMMERCIAL GRADE	
MAX	MAX ON CENTER	STD	MIN	MAX	STD	MIN	DYNATORQUE	DT36 NS
ϕ 9.000 3/4-10 UNC	ϕ 7.875 3/4-10 UNC	ϕ 6.496 3/4-10 UNC	ϕ 6.000 5/8-11 UNC	ϕ 4.000 1.00 X .75 KEY	ϕ 3.250 .750 KEY @C	ϕ 1.625		

33-42XXNS SHEET 1 OF 2 7/07/05

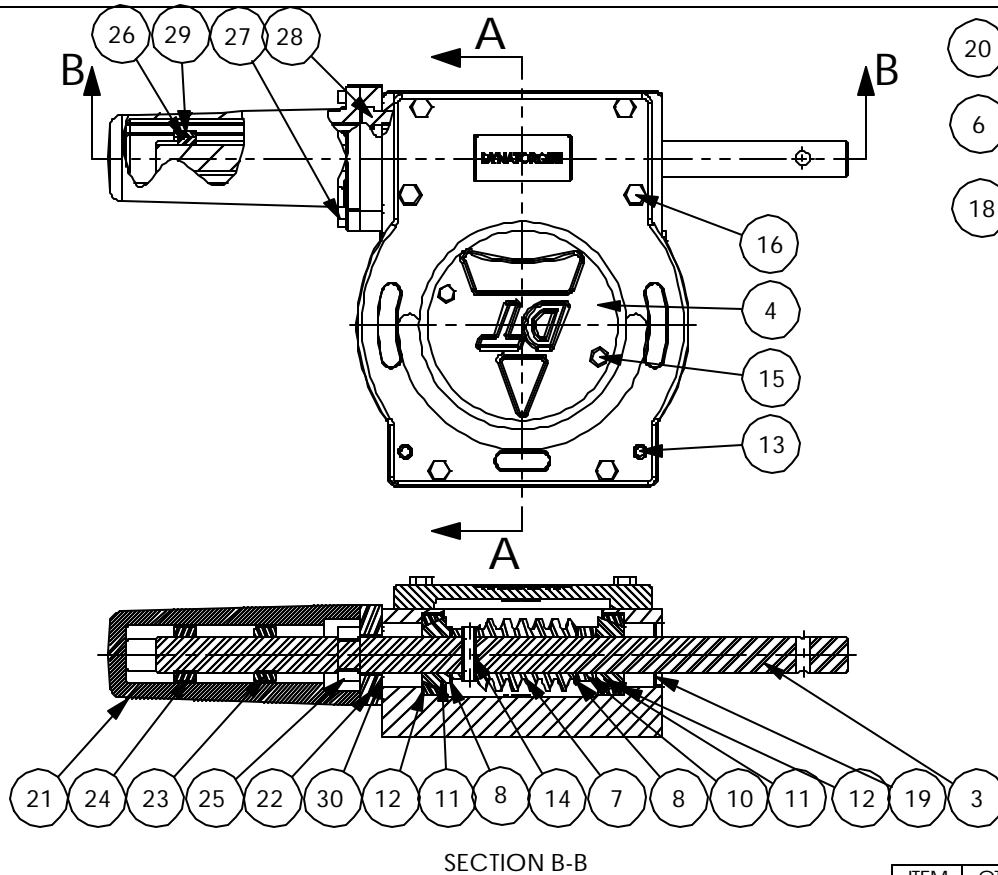

SECTION A-A

- 5 UNIT IS PAINTED BLACK OXIDE.
- 9 UNIT BEARINGS, O-RINGS, AND GEAR TEETH ARE GREASED.

ITEM	QTY.	DESCRIPTION	ITEM	QTY.	DESCRIPTION
1	1	HOUSING, DT36NS	18	2	O-RING,2-157
2	1	W/WHEEL,DT36, 360	19	1	LIP SEAL,1.00
3	1	SHAFT, DT36NS	20	1	GASKET,DT36
4	1	INDICATOR,DT36,STD	21	1	RETAINER, TRAVELING NUT, MACH
5	1	BLACK OXIDE	22	1	ADAPTER PLATE, NUT STOP
6	1	COVER,DT36, 360 DEG	23	1	TRAVELING NUT, 300 FT-LB
7	1	WORM,DT36	24	1	STOP, TRAVELING NUT, 300 FT-LB
8	2	THRUST WASHER,1.00,.061	25	1	STOP COLLAR, SPLIT
9	1	GREASE, COMMERCIAL GRADE	26	1	KEY, SQUARE, .250, .500
10	1	SPACER	27	4	SHCS, 1/4-20 X .75
11	2	ROLLER BRG, CONE	28	4	SHCS, 3/8-16 X .875
12	2	ROLLER BRG, CUP	29	1	SET SCREW, 6-32 X .125
13	2	DOWEL PIN,.375,1.00	30	1	GASKET
14	1	COIL PIN,.375,1.50	DYNATORQUE WWW.DYNATORQUE.COM		DT36 NS
15	2	HHCS,1/4-20 X .75 LG			
16	6	HHCS, 3/8-16 X 1.25 LG			
17	2	SET SCREW, 5/8-11, .50			