

CONSULT FACTORY FOR SPECIAL SHAFT AND INDICATOR CONFIGURATIONS

| | | | | | |
|--------------|--------------------|---|--|---|---|
| <p>POS 1</p> | <p>POS 2 (STD)</p> | <p>KEYWAY DIAGRAM</p> <p>IN OPEN POS.</p> | <p>GREASED FOR LIFE</p> <p>PLATED STANDARD SHAFT</p> <p>MAX STEM HEIGHT: 3.12 [79.2]</p> <p>WORM WHEEL RECESS: .25 [6.4]</p> | <p>HANDWHEEL</p> <p>RECOMMENDED ϕ: 36 IN</p> <p>RIM PULL AT MAX TORQUE: 77 LBS</p> <p>TURNS FOR 90°: 15</p> | <p>RATIO: 60:1</p> <p>TORQUE: 26,000 IN LBS [2963 N-M]</p> <p>TEMPERATURE: -20° TO 150°F [-29° TO 66°C]</p> <p>EST. WEIGHT: 45 LBS [20.5 KGS]</p> |
|--------------|--------------------|---|--|---|---|

| HOUSING MOUNTING PATTERN | | | | BORE & KEY | | | MANUAL 180° ACTUATOR COMMERCIAL GRADE | |
|----------------------------|----------------------------|----------------------------|----------------------------|------------------------------------|--------------------------------|--------------|--|------------|
| MAX | MAX ON CENTER | STD | MIN | MAX | STD | MIN | DYNATORQUE WWW.DYNATORQUE.COM | DT21 NS |
| $\phi 7.000$ 3/4-10 UNC | $\phi 5.625$ 3/8-16 UNC | $\phi 5.512$ 5/8-11 UNC | $\phi 4.500$ 5/8-11 UNC | $\phi 2.750$.625 X .438 KEY | $\phi 2.500$.500 KEY @C | $\phi 1.500$ | | |

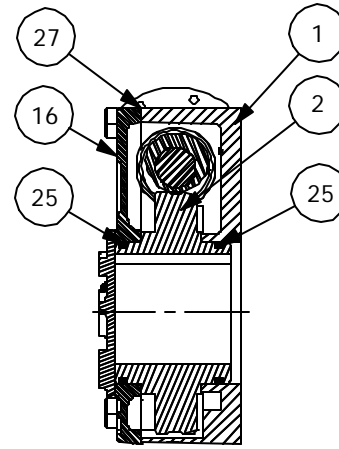
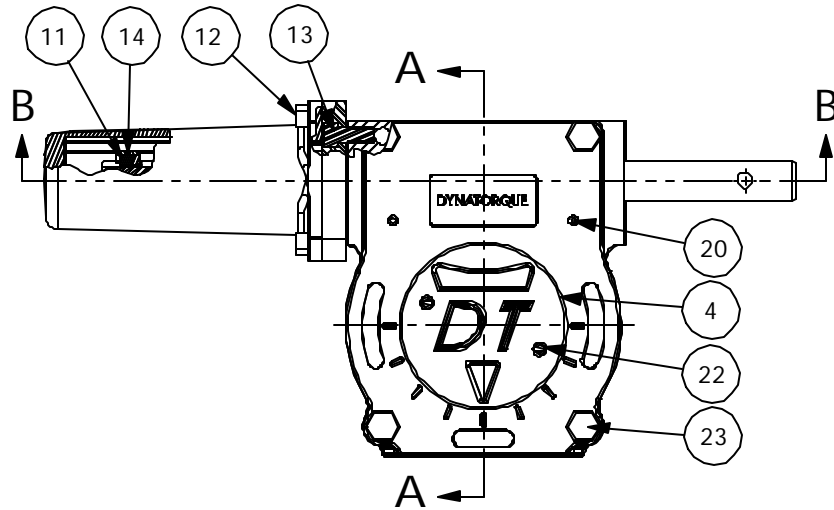

SECTION A-A

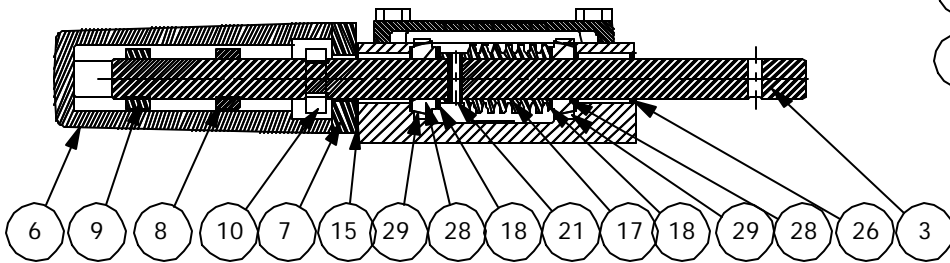
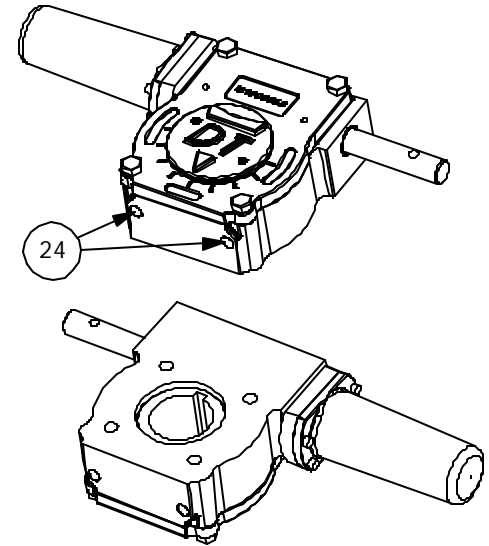

SECTION B-B

- 5 UNIT IS PAINTED BLACK OXIDE.
- 19 UNIT BEARINGS, O-RINGS AND GEAR TEETH ARE GREASED.

| ITEM | QTY. | DESCRIPTION | ITEM | QTY. | DESCRIPTION |
|------|------|--------------------------------|------|------|----------------------------------|
| 1 | 1 | HOUSING,DT21NS, 360 | 18 | 2 | THRUST WASHER,1.00,.061 |
| 2 | 1 | W/WHEEL,DT21 | 19 | 1 | GREASE, COMMERCIAL GRADE |
| 3 | 1 | SHAFT, DT21, NUTSTOP | 20 | 2 | DOWEL PIN,.250,.75 |
| 4 | 1 | INDICATOR,DT16/21 | 21 | 1 | COIL PIN,.375,1.25 |
| 5 | 1 | BLACK OXIDE | 22 | 2 | S/TAP SCREW, HEX HD., 8-32 X .50 |
| 6 | 1 | RETAINER, TRAVELING NUT, MACH | 23 | 4 | SHCS, 1/2-13 X 1.00 LG |
| 7 | 1 | ADAPTER PLATE, NUT STOP | 24 | 2 | SET SCREW, 5/8-11, .50 |
| 8 | 1 | TRAVELING NUT, 300 FT-LB | 25 | 2 | O-RING,2-236 |
| 9 | 1 | STOP, TRAVELING NUT, 300 FT-LB | 26 | 1 | LIP SEAL,1.00 |
| 10 | 1 | STOP COLLAR, SPLIT | 27 | 1 | COVER GASKET,DT16/21 |
| 11 | 1 | KEY, SQUARE, .250, .500 | 28 | 2 | ROLLER BRG, CONE |
| 12 | 4 | SHCS, 1/4-20 X .75 | 29 | 2 | ROLLER BRG, CUP |
| 13 | 4 | SHCS, 3/8-16 X .875 | | | |
| 14 | 1 | SET SCREW, 6-32 X .125 | | | |
| 15 | 1 | GASKET | | | |
| 16 | 1 | COVER,DT16/21, 360/180 | | | |
| 17 | 1 | WORM,DT21 | | | |

DYNATORQUE

WWW.DYNATORQUE.COM

**DT21
NS**