

CONSULT FACTORY FOR SPECIAL
SHAFT AND INDICATOR CONFIGURATIONS.

<p>POS 1</p>		<p>POS 2 (STD)</p>		<p>KEYWAY DIAGRAM</p> <p>IN OPEN POS.</p>		<p>GREASED FOR LIFE</p> <p>PLATED STANDARD SHAFT</p> <p>MAX STEM HEIGHT: 3.12 [79.2]</p> <p>WORM WHEEL RECESS: .25 [6.4]</p>		<p>HANDWHEEL</p> <p>RECOMMENDED Ø: 30 IN</p> <p>RIM PULL AT MAX TORQUE: 77 LBS</p> <p>TURNS FOR 360°: 60</p>		<p>RATIO: 60:1</p> <p>TORQUE: 26,000 IN LBS [2963 N-M]</p> <p>TEMPERATURE: -20° TO 150°F [-29° TO 66°C]</p> <p>EST. WEIGHT: 34 LBS [15.5 KGS]</p>	
<p>HOUSING MOUNTING PATTERN</p>				<p>BORE & KEY</p>			<p>MANUAL MULTI TURN WORM GEAR OPERATOR COMMERCIAL GRADE</p>				
MAX	MAX ON CENTER	STD	MIN	MAX	STD	MIN	<p>DYNATORQUE</p> <p>1934 E. SHERMAN MUSKEGON, MI 49444-1824 (231) 739-1377 FAX (231) 739-4514 WWW.DYNATORQUE.COM 4/1/05</p>		<p>DT21</p>		
Ø7.000 3/4-10 UNC	Ø5.625 3/8-16 UNC	Ø5.512 5/8-11 UNC	Ø4.500 5/8-11 UNC	Ø2.750 .625 X .438 KEY	Ø2.500 .500 KEY @C	Ø1.500					

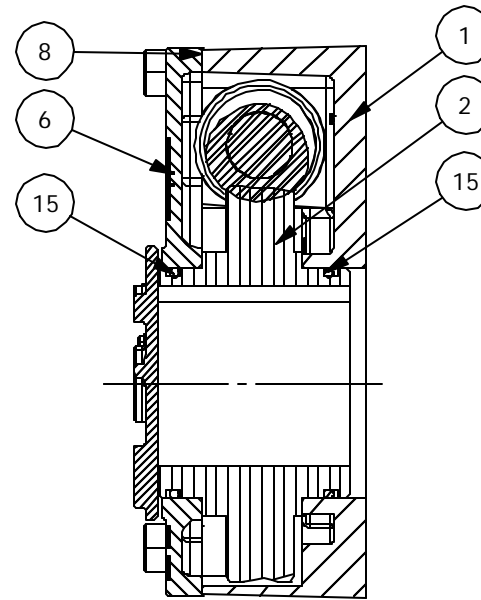

SECTION A-A

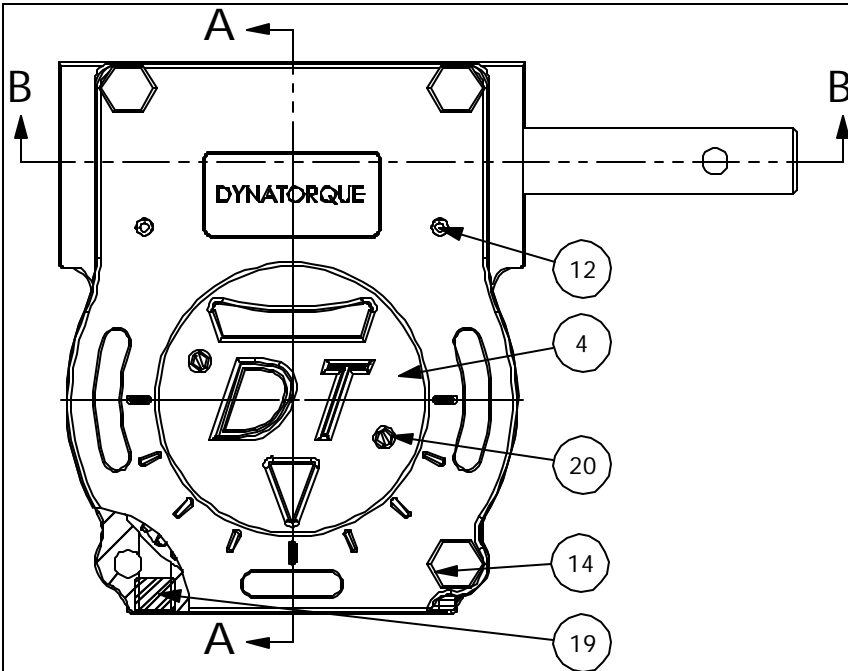
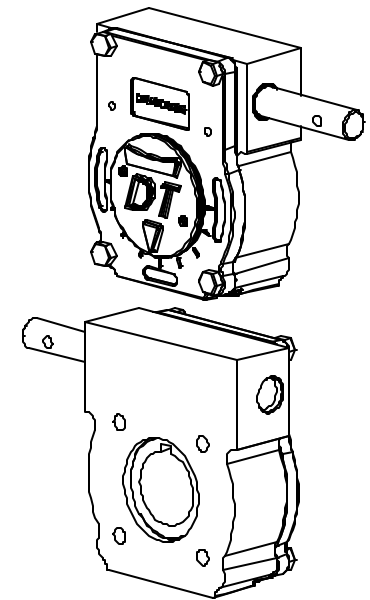

- 5 UNIT IS PAINTED BLACK OXIDE.
- 10 UNIT BEARINGS, O-RINGS AND GEAR TEETH ARE GREASED.

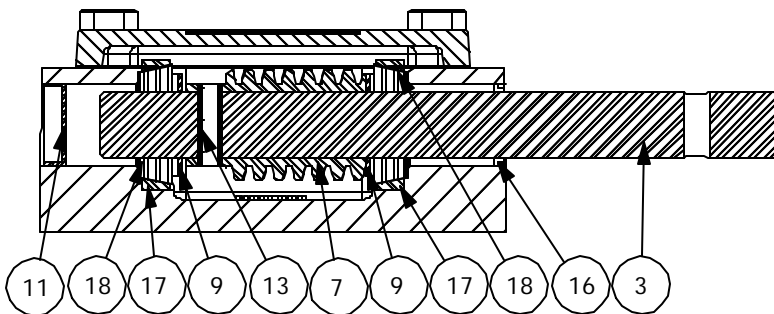

SECTION B-B

ITEM	QTY.	DESCRIPTION	ITEM	QTY.	DESCRIPTION
1	1	HOUSING,DT21	13	1	COIL PIN,.375,1.25
2	1	W/WHEEL,DT21	14	4	HHCS, 1/2-13 X 1.00 LG
3	1	SHAFT,DT21,G=7.59,.391	15	2	O-RING,2-236
4	1	INDICATOR,DT16/21	16	1	LIP SEAL,1.00
5	1	BLACK OXIDE	17	2	ROLLER BRG, CUP
6	1	COVER,DT16/21, 360/180	18	2	ROLLER BRG, CONE
7	1	WORM,DT21	19	2	SET SCREW, 5/8-11, .50
8	1	COVER GASKET,DT16/21	20	2	S/TAP SCREW, HEX HD., 8-32 X .50
9	2	THRUST WASHER,1.00,.061	DYNATORQUE 1934 EAST SHERMAN BLVD MUSKEGON, MI 49444-1824 (231) 739-1377 FAX (231) 739-4514 WWW.DYNATORQUE.COM 4/1/05		
10	1	GREASE, COMMERCIAL GRADE			
11	1	EXPANSION PLUG,1.250,.31			
12	2	DOWEL PIN,.250,.75			

DT21