

CONSULT FACTORY FOR SPECIAL
SHAFT & INDICATOR CONFIGURATIONS

<p>POS 1</p>	<p>POS 2 (STD)</p>	<p>KEYWAY DIAGRAM</p>	<p>GREASED FOR LIFE</p> <p>PLATED STANDARD SHAFT</p> <p>MAX STEM HEIGHT: 2.12 [53.8]</p> <p>WORM WHEEL RECESS: .04 [1.0]</p>	<p>HANDWHEEL</p> <p>RECOMMENDED ϕ: 6 IN</p> <p>RIM PULL AT</p> <p>MAX TORQUE: 82 LBS</p> <p>URNS FOR 90°: 7.5</p>	<p>RATIO: 30:1</p> <p>TORQUE: 2,000 IN LBS [226 N-M]</p> <p>TEMPERATURE: -20° TO 150°F [-29° TO 66°C]</p> <p>WEIGHT: 4 LBS [1.8 KGS]</p>
--------------	--------------------	-----------------------	--	---	--

HOUSING MOUNTING PATTERN				BORE & KEY			MANUAL 1/4 TURN ACTUATOR COMMERCIAL GRADE	
MAX	MAX ON CENTER	STD	MIN	MAX	STD	MIN	DYNATORQUE	DT2
ϕ 3.750 3/8-16 UNC	ϕ 2.625 3/8-16 UNC	ϕ 3.250 3/8-16 UNC	ϕ 2.000 1/4-20 UNC	ϕ 1.250 .250 X .188 KEY	ϕ 1.000 .250 KEY @C	ϕ .391		

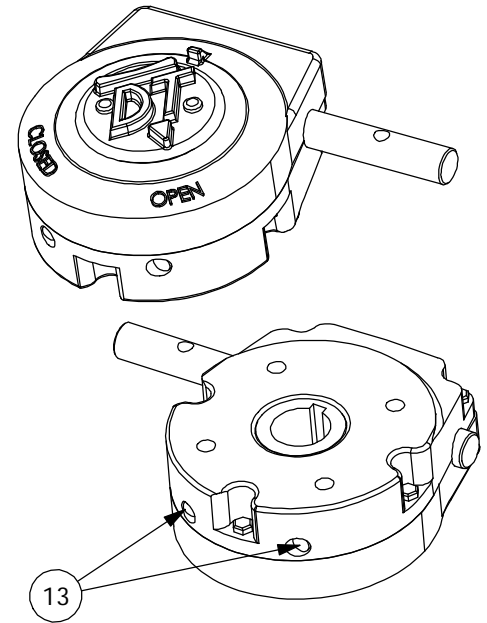
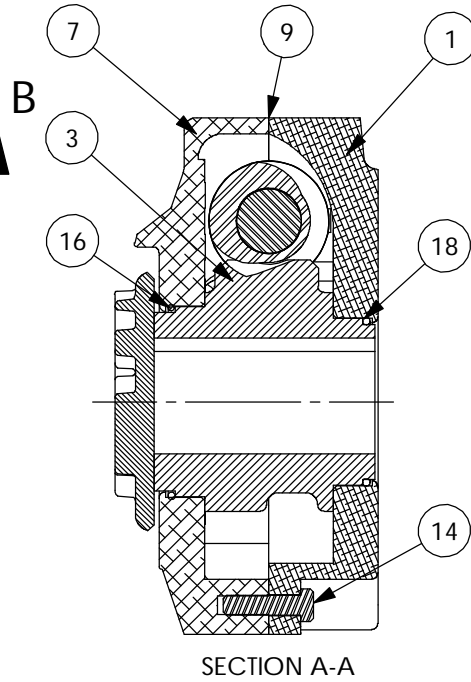
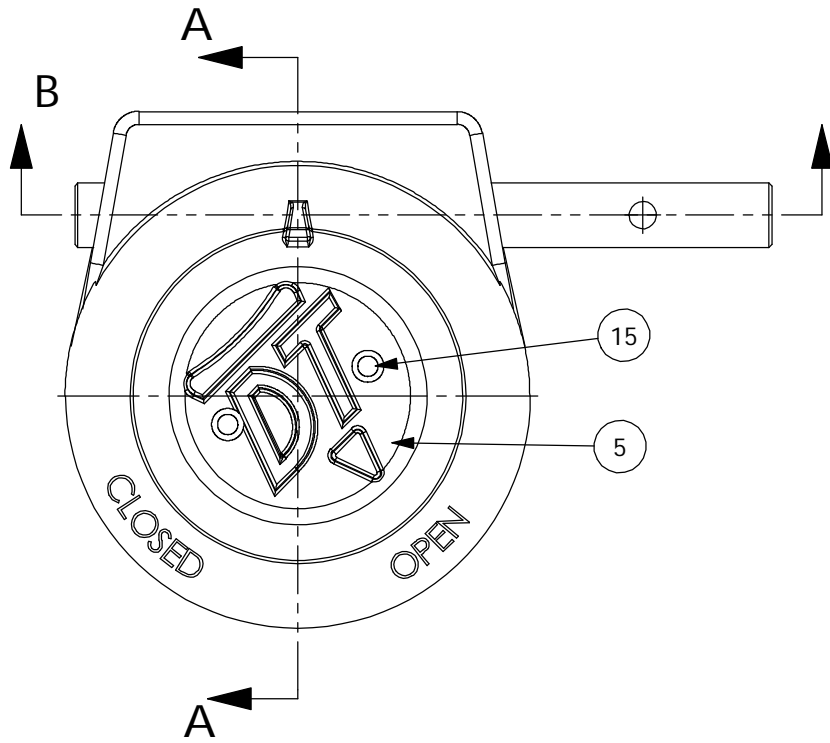

- 6 HOUSING, COVER, AND INDICATOR ARE PAINTED A BLACK EPOXY E-COAT.
- 11 UNIT BEARINGS, O-RINGS AND GEAR TEETH ARE GREASED.

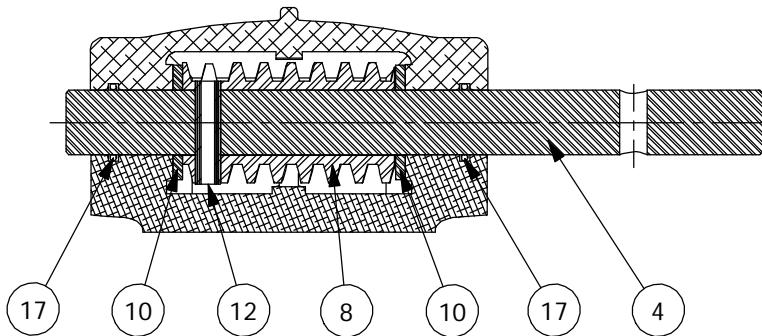

SECTION B-B

ITEM	QTY.	DESCRIPTION	ITEM	QTY.	DESCRIPTION
1	1	HOUSING,DT2	13	2	SET SCREW, 5/16-18, 1.50
2	1	PLASTIC PLUG FOR SHIPPING	14	5	S/TAP SCREW, HEX, 10-24 X .75
3	1	W/WHEEL, DT2	15	2	PHCS,8-32,S/TAP,.5
4	1	SHAFT,DT2	16	1	O-RING,2-030
5	1	INDICATOR, DT2/3	17	2	O-RING,2-016
6	1	E-COAT	18	1	O-RING,2-029
7	1	COVER,DT2,CAST,STD	DYNATORQUE 1934 EAST SHERMAN BLVD MUSKOGON, MI 49444-1824 (231) 739-1377 FAX (231) 739-4514 WWW.DYNATORQUE.COM		
8	1	WORM, DT2/3/5			
9	1	SEALANT #732 RTV,DOW			
10	2	THRUST WASHER,.625,.092			
11	1	GREASE, COMMERCIAL GRADE			
12	1	COIL PIN,.250,1.00			

DT2