

CONSULT FACTORY FOR SPECIAL
SHAFT AND INDICATOR CONFIGURATIONS.

33-27XXW SHEET 1 OF 2 8/28/03

<p>POS 1 POS 2 (STD)</p>		<p>KEYWAY DIAGRAM</p> <p>IN OPEN POS.</p>	<p>300 FT-LB STOPS BRONZE WORM WHEEL GREASED FOR LIFE PLATED STANDARD SHAFT MAX STEM HEIGHT: 3.12 [79.2] WORM WHEEL RECESS: .25 [6.4]</p>	<p>HANDWHEEL</p> <p>RECOMMENDED Ø: 36 IN RIM PULL AT MAX TORQUE: 77 LBS TURNS FOR 90°: 11</p>	<p>RATIO: 44:1 TORQUE: 16,000 IN LBS [1808 N-M] TEMPERATURE: -20° TO 150°F [-29° TO 66°C] EST. WEIGHT: 33 LBS [15 KGS]</p>			
<p>HOUSING MOUNTING PATTERN</p>				<p>BORE & KEY</p>			<p>MANUAL 1/4 TURN ACTUATOR AWWA GRADE</p>	
MAX	MAX ON CENTER	STD	MIN	MAX	STD	MIN	<p>DYNATORQUE</p> <p>1934 E. SHERMAN MUSKEGON, MI 49444-1824 (231) 739-1377 FAX (231) 739-4514 WWW.DYNATORQUE.COM</p>	<p>DT16W</p>
<p>Ø 7.000 3/4-10 UNC</p>	<p>Ø 6.000 1/2-13 UNC</p>	<p>Ø 6.000 5/8-11 UNC</p>	<p>Ø 4.500 5/8-11 UNC</p>	<p>Ø 2.750 .625 X .438 KEY</p>	<p>Ø 2.750 .250 KEYS @B, C</p>	<p>Ø 1.500</p>		

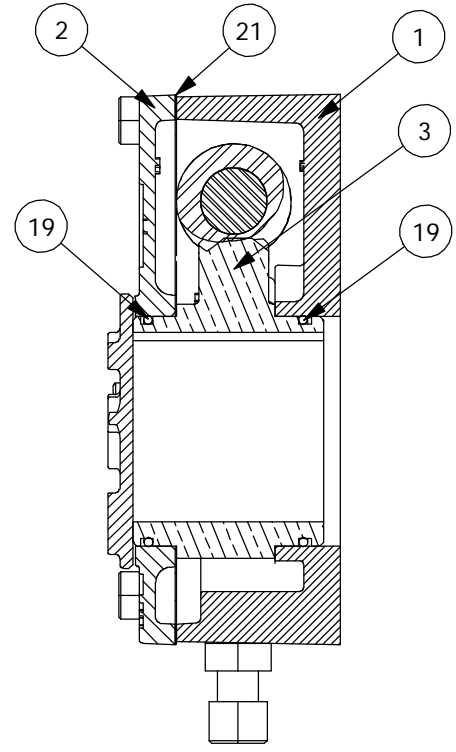
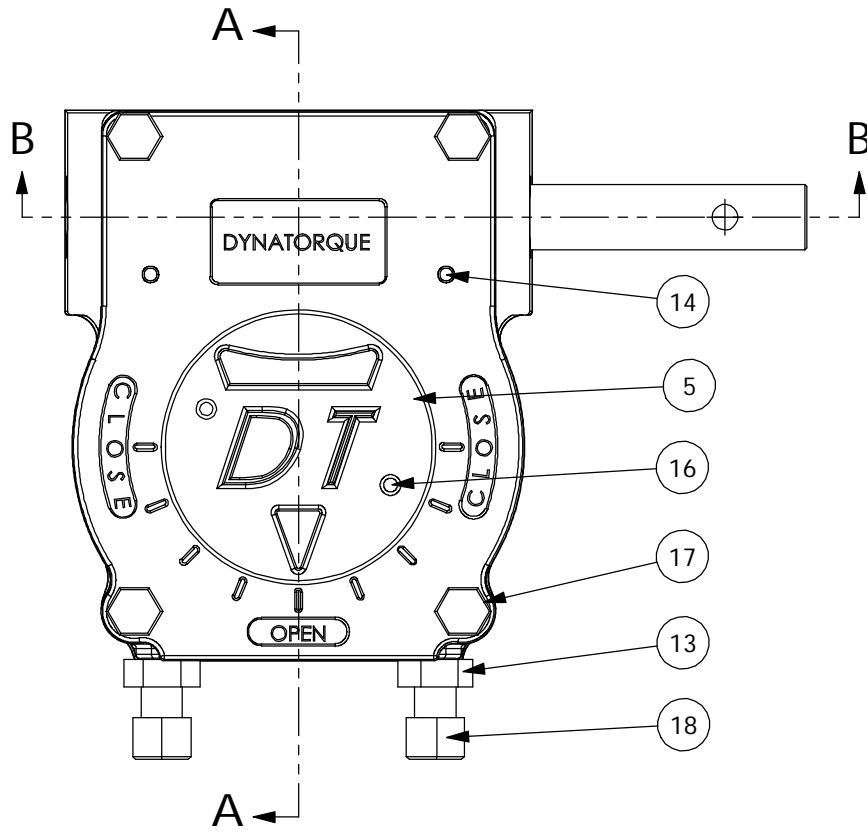

SECTION A-A

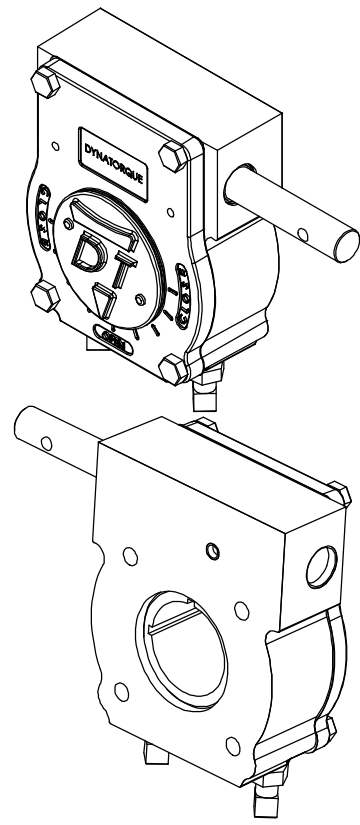

- 6 UNIT IS PAINTED BLACK OXIDE.
- 10 UNIT BEARINGS, O-RINGS AND GEAR TEETH ARE GREASED.

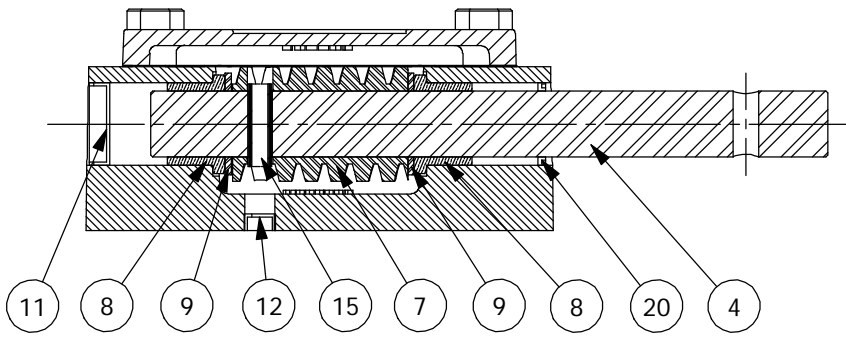

SECTION B-B

ITEM	QTY.	DESCRIPTION	ITEM	QTY.	DESCRIPTION
1	1	HOUSING, DT16	14	2	DOWEL PIN, .250, .75
2	1	COVER, DT16/21, MACH	15	1	COIL PIN, .375, 1.25
3	1	W/WHEEL, DT16W	16	2	PHCS, 8-32 S/TAP, .5
4	1	SHAFT, DT21	17	4	HHCS, 1/2-13 X 1.00 LG
5	1	INDICATOR, DT16/21	18	2	SHSS, 5/8-11 X 3.00
6	1	BLACK OXIDE	19	2	O-RING, 2-236
7	1	WORM, DT16	20	1	LIP SEAL, 1.00
8	2	BEARING, FLANGED, 1.25, 1.00, .88	21	1	COVER GASKET, DT16/21
9	2	THRUST WASHER, 1.00, .092	DYNATORQUE DT16W 1934 EAST SHERMAN BLVD MUSKEGON, MI 49444-1824 (231) 739-1377 FAX (231) 739-4514 WWW.DYNATORQUE.COM		
10	1	GREASE, COMMERCIAL GRADE			
11	1	EXPANSION PLUG, 1.250, .31			
12	1	EXPANSION PLUG, .468, .250			
13	2	NUT, JAM, 5/8-11			