

<p>POS 1</p>		<p>POS 2 (STD)</p>		<p>KEYWAY DIAGRAM</p>		<p>GREASED FOR LIFE</p> <p>PLATED STANDARD SHAFT</p> <p>MAX STEM HEIGHT: 4.44 [112.8]</p> <p>WORM WHEEL RECESS: .33 [8.4]</p>		<p>HANDWHEEL</p> <p>RECOMMENDED ϕ: 36 IN</p> <p>RIM PULL AT MAX TORQUE: 104 LBS</p> <p>TURNS FOR 90°: 90</p>		<p>RATIO: 360:1</p> <p>TORQUE: 140,000 IN LBS [15820 N-M]</p> <p>TEMPERATURE: -20° TO 150 °F [-29° TO 66 °C]</p> <p>EST. WEIGHT: 148 LBS [67.3 KGS]</p>	
<p>HOUSING MOUNTING PATTERN</p>				<p>BORE & KEY</p>		<p>MANUAL 1/4 TURN ACTUATOR COMMERCIAL GRADE</p>					
MAX	MAX ON CENTER	STD	MIN	MAX	STD	<p>DYNATORQUE</p> <p>WWW.DYNATORQUE.COM</p> <p>10/13/05</p>					
$\phi 11.750$ 3/4-10 UNC	$\phi 11.750$ 3/4-10 UNC	$\phi 10.250$ 3/4-10 UNC	$\phi 6.500$ 3/4-10 UNC	$\phi 4.500$ 1.25 X .625 KEY	$\phi 3.250$.750 KEY @C						

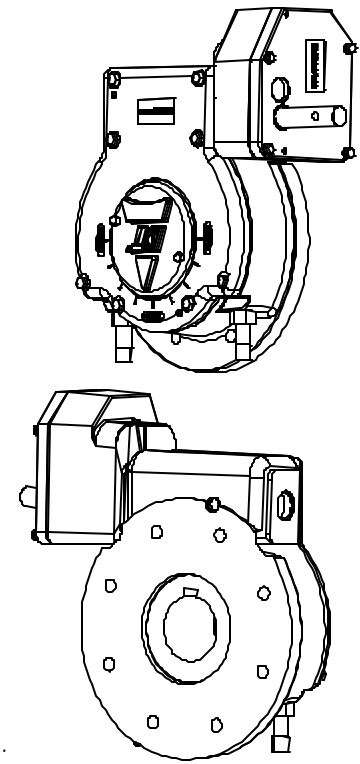

- 5 UNIT IS PAINTED BLACK OXIDE PRIMER.
- 11 UNIT BEARINGS, O-RINGS AND GEAR TEETH ARE GREASED.

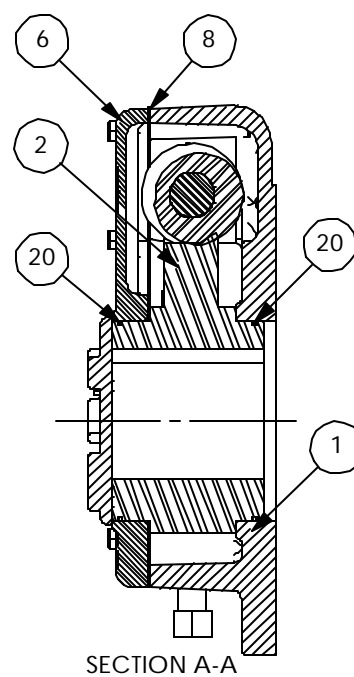
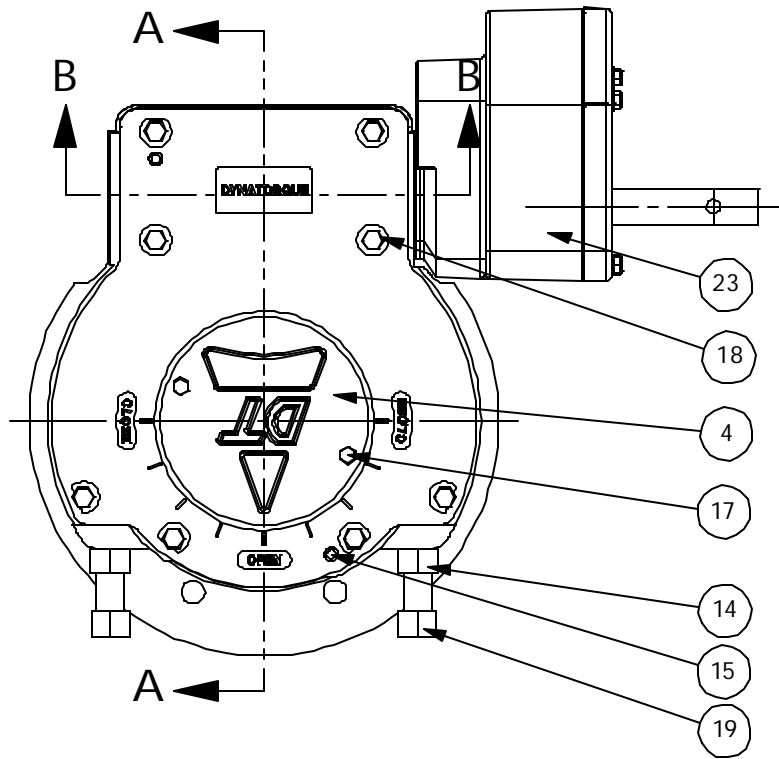
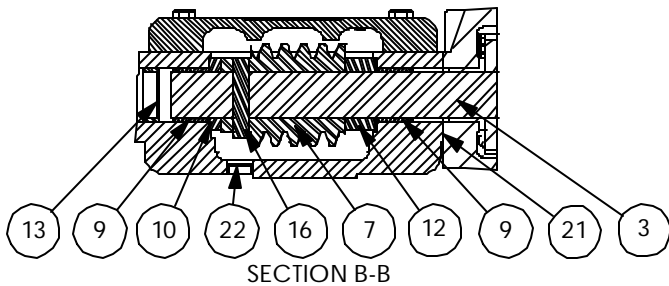

ITEM	QTY.	DESCRIPTION	ITEM	QTY.	DESCRIPTION
1	1	HOUSING, DT140	15	2	DOWEL PIN, .375, 1.00
2	1	W/WHEEL, DT60	16	1	GROOVE PIN, .438, 2.25
3	1	SHAFT, DT140, NEWSPUR	17	2	HHCS, 1/4-20 X .75 LG
4	1	INDICATOR, DT60, STD	18	8	HHCS, 3/8-16 X 1.50 LG
5	1	PAINT, PRIMER, BLACK OXIDE	19	2	SHSS, 3/4-10 X 4.50
6	1	COVER, DT60	20	2	O-RING, 2-160
7	1	WORM, DT140, STD	21	1	GASKET
8	1	COVER GASKET, DT 60/90	22	1	EXPANSION PLUG, .750, .25
9	2	BEARING SLV, 1.50, 1.25, 1.00	23	1	SPUR, 6:1, DT140
10	1	WORM SPACER, DT140	DYNATORQUE WWW.DYANTORQUE.COM DT140 10/13/05		
11	1	GREASE, COMMERCIAL GRADE			
12	1	WORM SPACER, DT140			
13	1	EXPANSION PLUG, 1.50, .48			
14	2	NUT, JAM, 3/4-10			