

CONSULT FACTORY FOR SPECIAL
SHAFT AND INDICATOR CONFIGURATIONS.

POS 1 		POS 2 (STD) 		KEYWAY DIAGRAM 		GREASED FOR LIFE PLATED STANDARD SHAFT MAX STEM HEIGHT: 2.75 [69.9] WORM WHEEL RECESS: .25 [6.4]		HANDWHEEL RECOMMENDED ϕ : 30 IN RIM PULL AT MAX TORQUE: 78 LBS TURNS FOR 360°: 57		RATIO: 57:1 TORQUE: 16,000 IN LBS [1808 N-M] TEMPERATURE: -20° TO 150°F [-29° TO 66°C] EST. WEIGHT: 26 LBS [11.8 KGS]		
HOUSING MOUNTING PATTERN				BORE & KEY			MANUAL MULTI TURN WORM GEAR OPERATOR COMMERCIAL GRADE					
MAX	MAX ON CENTER	STD	MIN	MAX	STD	MIN	DYNATORQUE 1934 E. SHERMAN MUSKEGON, MI 49444-1824 (231) 739-1377 FAX (231) 739-4514 WWW.DYNATORQUE.COM 4/1/05					DT12
ϕ 6.500 3/4-10 UNC	ϕ 5.250 1/2-13 UNC	ϕ 4.921 1/2-13 UNC	ϕ 3.750 3/8-16 UNC	ϕ 2.250 .500 X .375 KEY	ϕ 2.000 .375 KEY @C	ϕ 1.125						

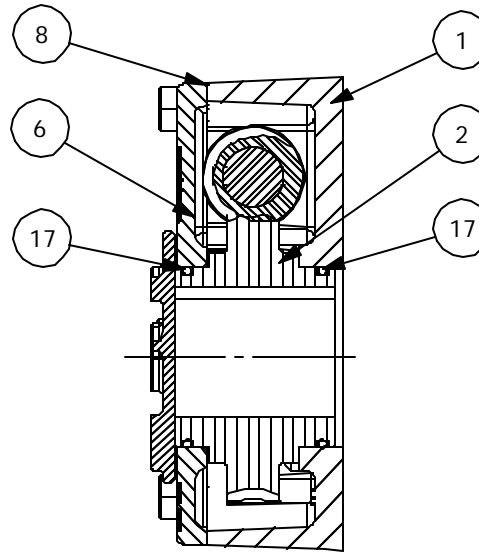

SECTION A-A

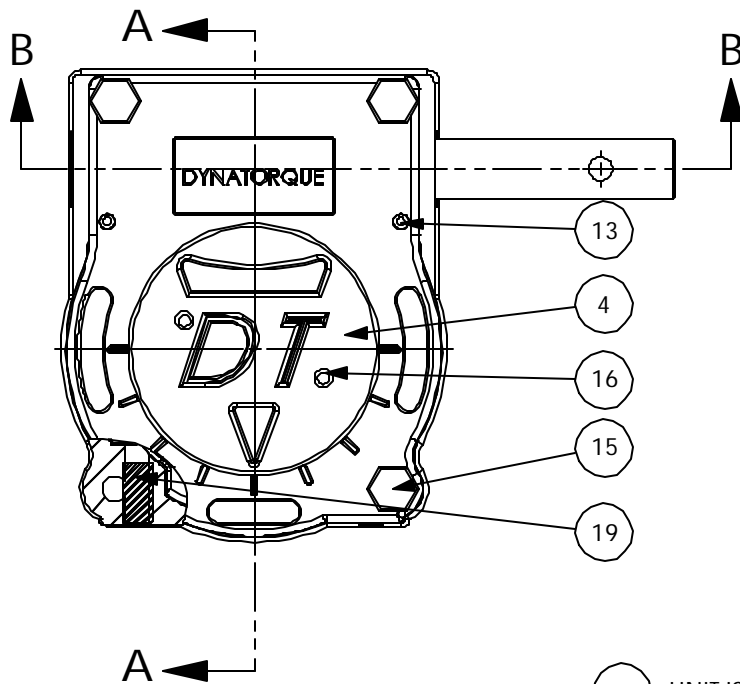
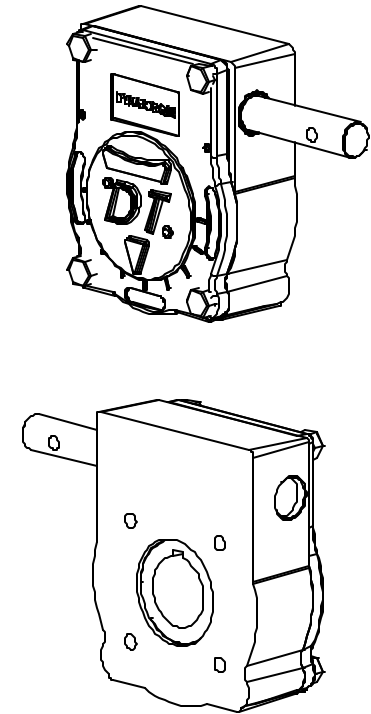

- 5 UNIT IS PAINTED BLACK OXIDE.
- 11 UNIT BEARINGS, O-RINGS AND GEAR TEETH ARE GREASED.

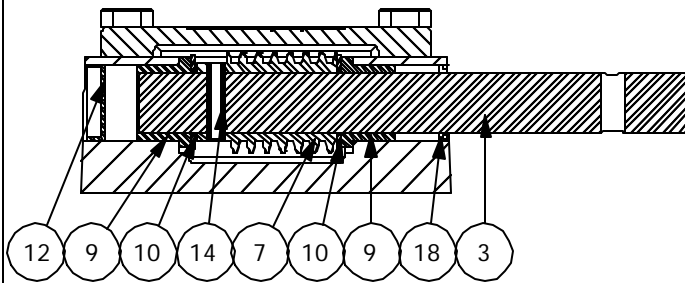

SECTION B-B

ITEM	QTY	DESCRIPTION	ITEM	QTY	DESCRIPTION
1	1	HOUSING,DT12	13	2	DOWEL PIN,.250,.75
2	1	W/WHEEL, DT12, 360°	14	1	COIL PIN,.313,1.25
3	1	SHAFT,DT8/12,G=7.00,.391	15	4	HHCS, 1/2-13 X 1.00 LG
4	1	INDICATOR,DT12, STD	16	2	PHCS,8-32,S/TAP,.5
5	1	BLACK OXIDE	17	2	O-RING,2-232
6	1	COVER,DT12,180/360,STD	18	1	LIP SEAL,1.00
7	1	WORM, DT12	19	2	SET SCREW,1/2-13, 1.00
8	1	COVER GASKET, DT12			
9	2	BEARING,FLANGED,1.250,1.000,.880			
10	2	THRUST WASHER,1.00,.092			
11	1	GREASE, COMMERCIAL GRADE			
12	1	EXPANSION PLUG,1.250,.31			

DYNATORQUE
 1934 EAST SHERMAN BLVD
 MUSKEGON, MI 49444-1824
 (231) 739-1377 FAX (231) 739-4514
 WWW.DYNATORQUE.COM
 4/1/05

DT12