

CONSULT FACTORY FOR  
SPECIAL DRIVER AND  
SHAFT CONFIGURATIONS.

<p>POS 1</p>	<p>POS 2 (STD)</p>	<p>KEYWAY DIAGRAM</p> <p>IN OPEN POS.</p>	<p>GREASED FOR LIFE</p> <p>PLATED STANDARD SHAFT</p> <p>MAX STEM HEIGHT: 2.75 [69.9]</p> <p>WORM WHEEL RECESS: .25 [6.4]</p>	<p>HANDWHEEL</p> <p>RECOMMENDED <math>\phi</math>: 30 IN</p> <p>RIM PULL AT MAX TORQUE: 78 LBS</p> <p>TURNS FOR 90°: 14.25</p>	<p>RATIO: 57:1</p> <p>TORQUE: 16,000 IN LBS [1808 N-M]</p> <p>TEMPERATURE: -20° TO 150°F [-29° TO 66°C]</p> <p>EST. WEIGHT: 26 LBS [11.8 KGS]</p>
--------------	--------------------	---	--	--	---

**HOUSING MOUNTING PATTERN**

**BORE & KEY**

**MANUAL 1/4 TURN ACTUATOR  
COMMERCIAL GRADE**

MAX	MAX ON CENTER	STD	MIN	MAX	STD	MIN
$\phi$ 6.500 3/4-10 UNC	$\phi$ 5.250 1/2-13 UNC	$\phi$ 4.921 1/2-13 UNC	$\phi$ 3.750 3/8-16 UNC	$\phi$ 2.250 .500 X .375 KEY	$\phi$ 2.000 .375 KEY @C	$\phi$ 1.125

**DYNATORQUE**

**DT12**

1934 E. SHERMAN MUSKEGON, MI 49444-1824  
(231) 739-1377 FAX (231) 739-4514  
WWW.DYNATORQUE.COM

33-28XX SHEET 1 OF 2 7/31/03

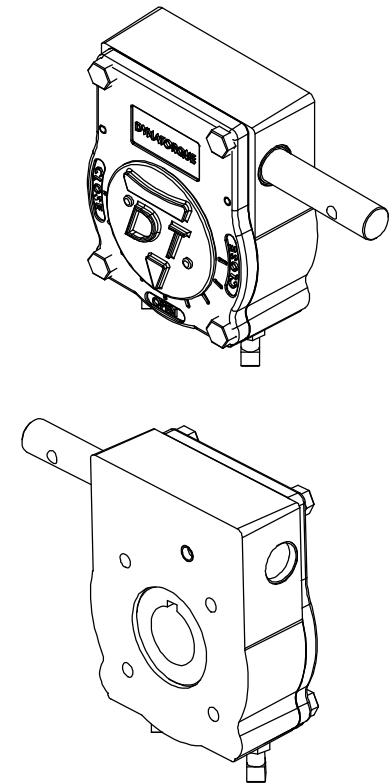
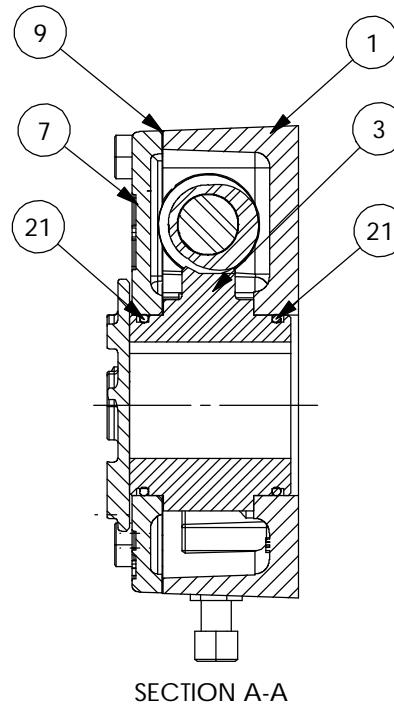
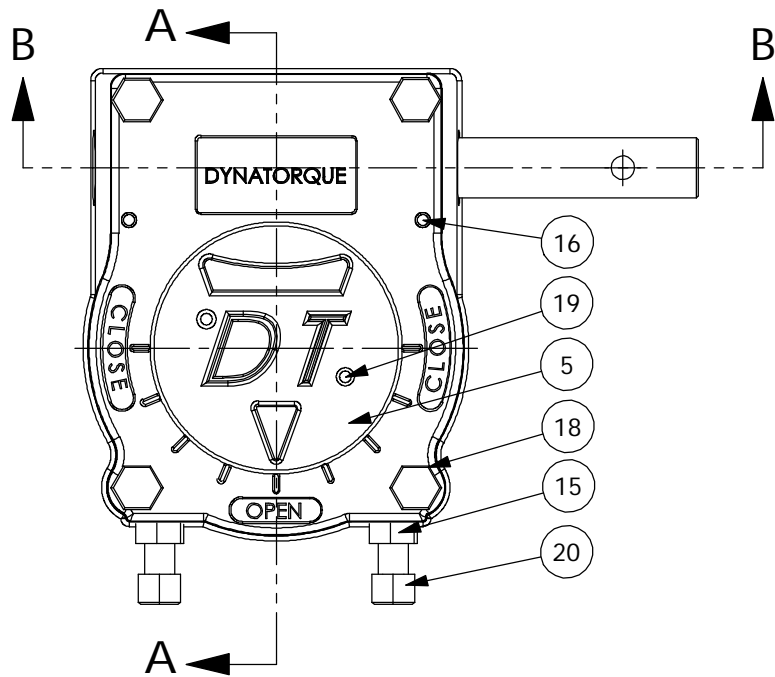

- 6 UNIT IS PAINTED BLACK OXIDE.
- 12 UNIT BEARINGS, O-RINGS AND GEAR TEETH ARE GREASED.

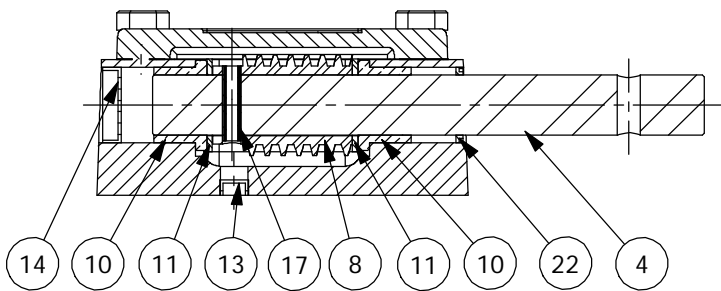

SECTION B-B

ITEM	QTY.	DESCRIPTION	ITEM	QTY.	DESCRIPTION
1	1	HOUSING,DT12	14	1	EXPANSION PLUG,1.250,.31
2	4	PLASTIC PLUG FOR SHIPPING	15	2	NUT,JAM,1/2-13
3	1	W/WHEEL, DT12	16	2	DOWEL PIN,.250,.75
4	1	SHAFT,DT12,STD	17	1	COIL PIN,.313,1.25
5	1	INDICATOR,DT12, STD	18	4	HHCS, 1/2-13 X 1.00 LG
6	1	BLACK OXIDE	19	2	PHCS,8-32,S/TAP,.5
7	1	COVER, DT12, STD	20	2	SHSS, 1/2-13 X 3.00
8	1	WORM, DT12	21	2	O-RING,2-232
9	1	COVER GASKET, DT12	22	1	LIP SEAL,1.00
10	2	BEARING,FLANGED,1.25,1.00,.88			<b>DYNATORQUE</b> 1934 EAST SHERMAN BLVD MUSKEGON, MI 49444-1824 (231) 739-1377 FAX (231) 739-4514 WWW.DYNATORQUE.COM
11	2	THRUST WASHER,1.00,.092			
12	1	GREASE, COMMERCIAL GRADE			
13	1	EXPANSION PLUG,.468,.250			

**DT12**